

VISITOR GUIDE

Welcome to the Musée d'Art et d'Histoire!
Built by the Genevan architect Marc Camoletti to bring together various public collections, the museum opened in 1910. Its holdings are very diverse: paintings and sculptures, works on paper, archaeological collections, furniture and household items, arms, musical instruments, textiles, clocks and watches, as well as enamel and jewellery. Of these, only a small portion, about 650,000 objects, is on permanent view. Temporary exhibitions allow for new aspects to be presented on a regular basis.

We invite you to discover the Musée d'Art et d'Histoire (MAH) by following what pulls you in and what matches your taste. There's no set museum visit. Spend a few minutes or a few hours and enjoy what you discover!

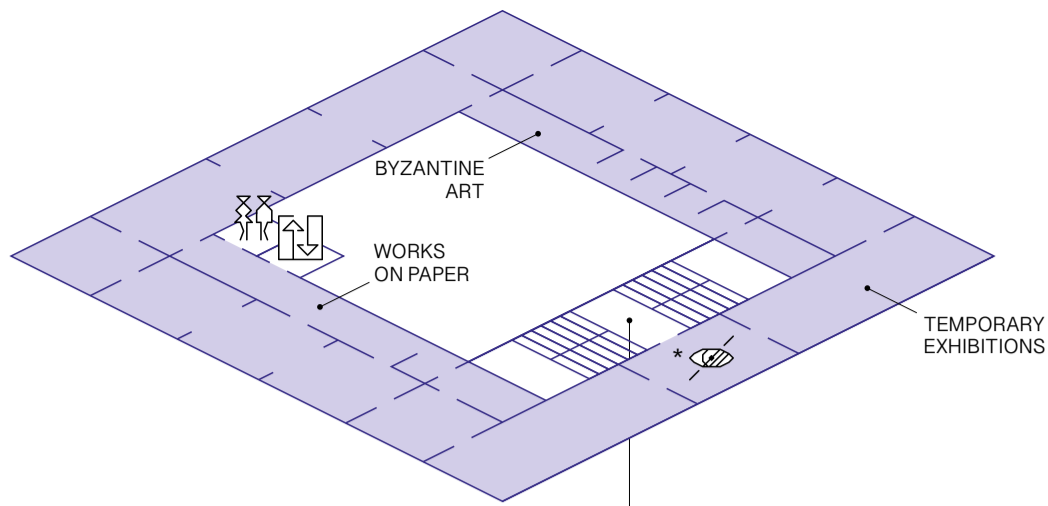



LEVEL 2 FINE ARTS WORKS ON PAPER & BYZANTINE ART

The upper level presents paintings, sculptures, and works on paper. The trajectory is chronological from the fifteenth century to the 1930s, highlighting key points in the collection. The visit begins with Konrad Witz's altar panels. One side consists of the renowned *The Miraculous Draught of Fishes*, the oldest topographically accurate landscape in Western easel painting. Genevan and Swiss artists, including Alexandre Calame and Ferdinand Hodler, are honoured at the heart of the Italian, French, and Northern European schools. The focus is on portraits and landscapes.

Large pieces are exhibited in the big galleries. Smaller ones and works on paper are rotated regularly for conservation purposes and presented in small display cases (located along the courtyard). A large gallery is dedicated to the temporary M exhibitions (twice annually) and Byzantine art.

*  Sensory maps with audio commentary are available.

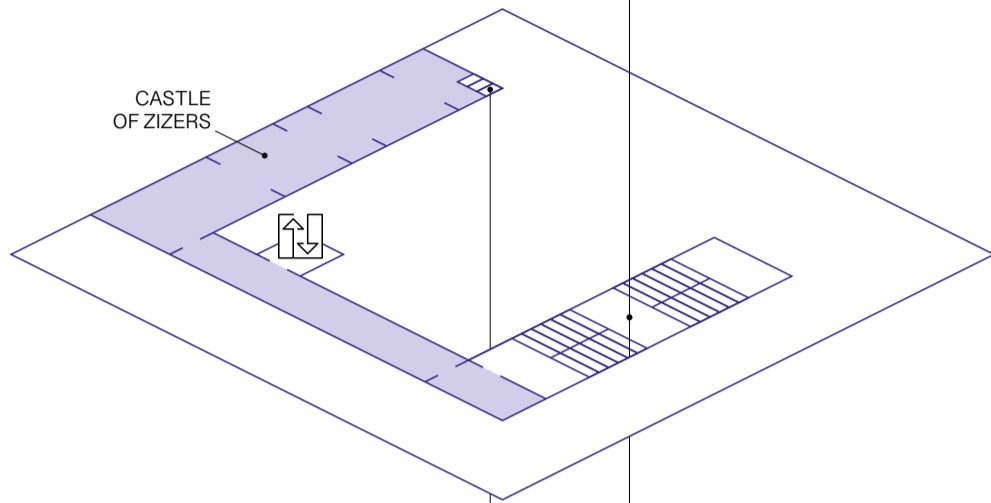

LEVEL 1 APPLIED ARTS CASTLE OF ZIZERS

The museum's mezzanine floor is dedicated to the applied arts. Presentations are rotated on a regular basis. There are also historical rooms from the Castle of Zizers in the canton of Grisons (the castle's oval ceremonial room is located on level 1). These spaces invite visitors to plunge into the late seventeenth century with its sculpted panelling, earthenware stoves, and medieval windows with stained glass.

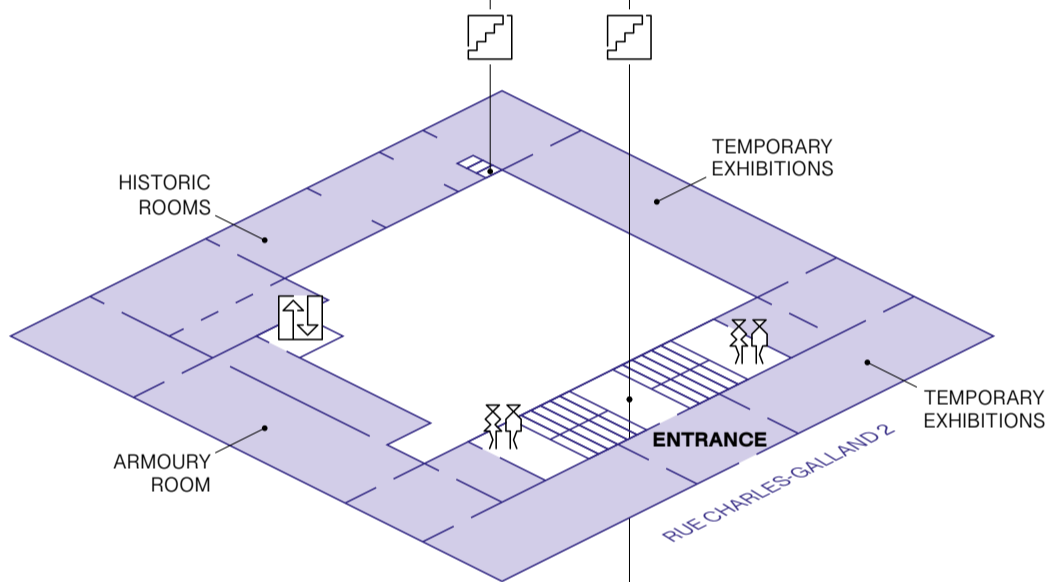

LEVEL 0 RECEPTION TEMPORARY EXHIBITIONS

The main entrance is located on Rue Charles-Galland. This level is dedicated to temporary exhibitions, whether entirely (XL exhibitions, late January–late June) or in part (L exhibitions, July–October). There are also historical rooms. The mural and/or ceiling decorations, and sometimes even the floor, are from historical buildings and are typical of early twentieth-century museography when the museum was being built.

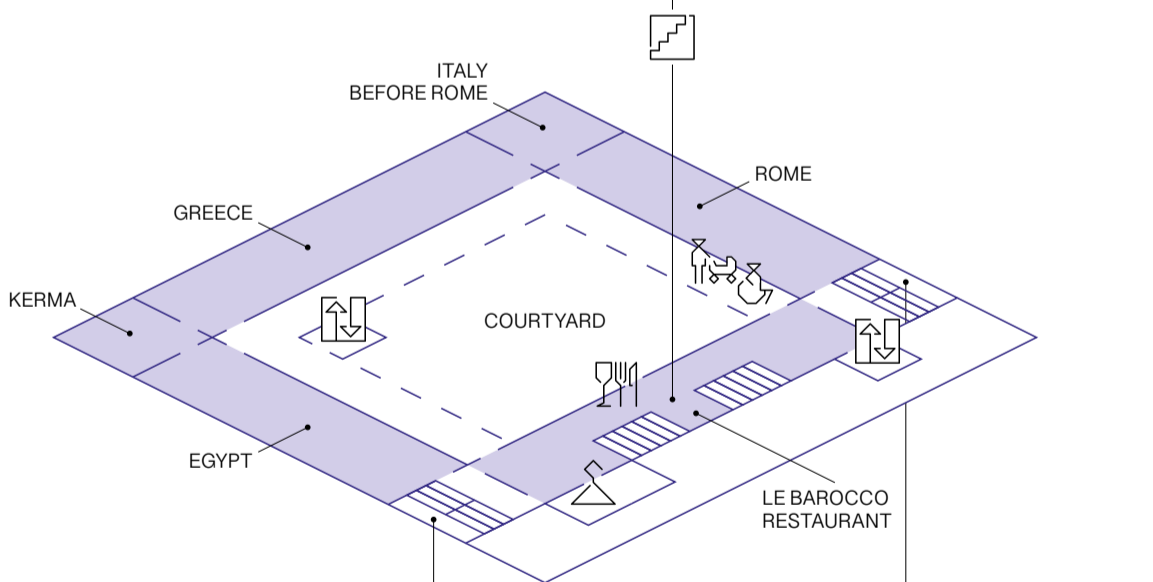

LEVEL -1 ARCHAEOLOGY COURTYARD

Mediterranean antiquities are on view along the two boulevards that run parallel to the museum. The gallery devoted to Ancient Egypt presents several pieces, including a colossal statue of Ramses II from the archaeology trips of Genevan Egyptologists Édouard and Marguerite Naville. Sudanese archaeology is represented by the site of Kerma, which was excavated by a Swiss archaeological team for almost fifty years. The gallery dedicated to Greece plunges into mythology with famous episodes that are painted on vases, such as *The Birth of Athena* or *Hercules Killing the Nemean Lion* and through Roman copies of the renowned statues of Praxiteles. Pre-Rome Italy and Rome—where the silver dish known as *The Charioteer* is on view—complete the antiquities tour.

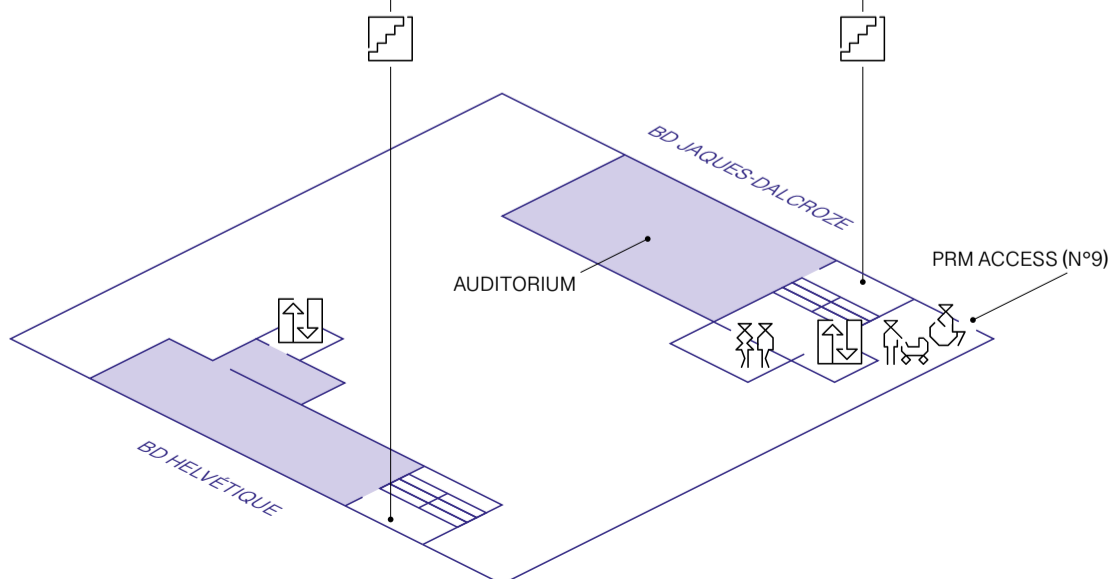

LEVEL -2 REGIONAL ARCHAEOLOGY AUDITORIUM

The oldest records of human settlement in the region of Geneva are on view in the Regional Archaeology gallery. The presentation spans from the Upper Palaeolithic to around the year 1000, a chronological trajectory of 14,000 years. The exceptional Gallo-Roman oak statue, more than nine metres high, has miraculously been conserved and watches over the treasures here.

The Auditorium is on the other side of the building and can be accessed via level -1.

Enjoy an immersive adventure into the museum's treasures. Scan the QR code for audio guides and point at the objects you're curious about to discover their secrets.





LE BAROCCO

The MAH restaurant, Le Barocco, is inspired by local Genevan traditions and specialises in homemade pastries. During warm weather months, an outdoor terrace invites visitors into the museum's inner courtyard to take a pleasant pause. The restaurant is open during the MAH's visiting hours.
Information and bookings: T +41 (0)22 418 26 82

ONLINE SHOP

Catalogues, accessories, and various other items are available at shop.mahmah.ch.

GENERAL INFORMATION

MAH — Musée d'Art et d'Histoire
Rue Charles-Galland 2, 1206 Geneva
T +41 (0)22 418 26 00 (Monday to Friday)
mah@geneve.ch
mahmah.ch
   [mahgeneve](https://www.youtube.com/mahgeneve)

Open from Tuesday to Sunday, 11 am to 6 pm,
Thursdays, from 12 pm to 9 pm. Le Barocco opens at 11:45 am.

Pay what you wish!

Discover the exhibitions, collection, and events at mahmah.ch.
Online ticketing: billetterie.mahmah.ch

**Un musée
Ville de Genève**

geneve.ch

